

ALMA MANOR NURSING CENTER ALMA KS

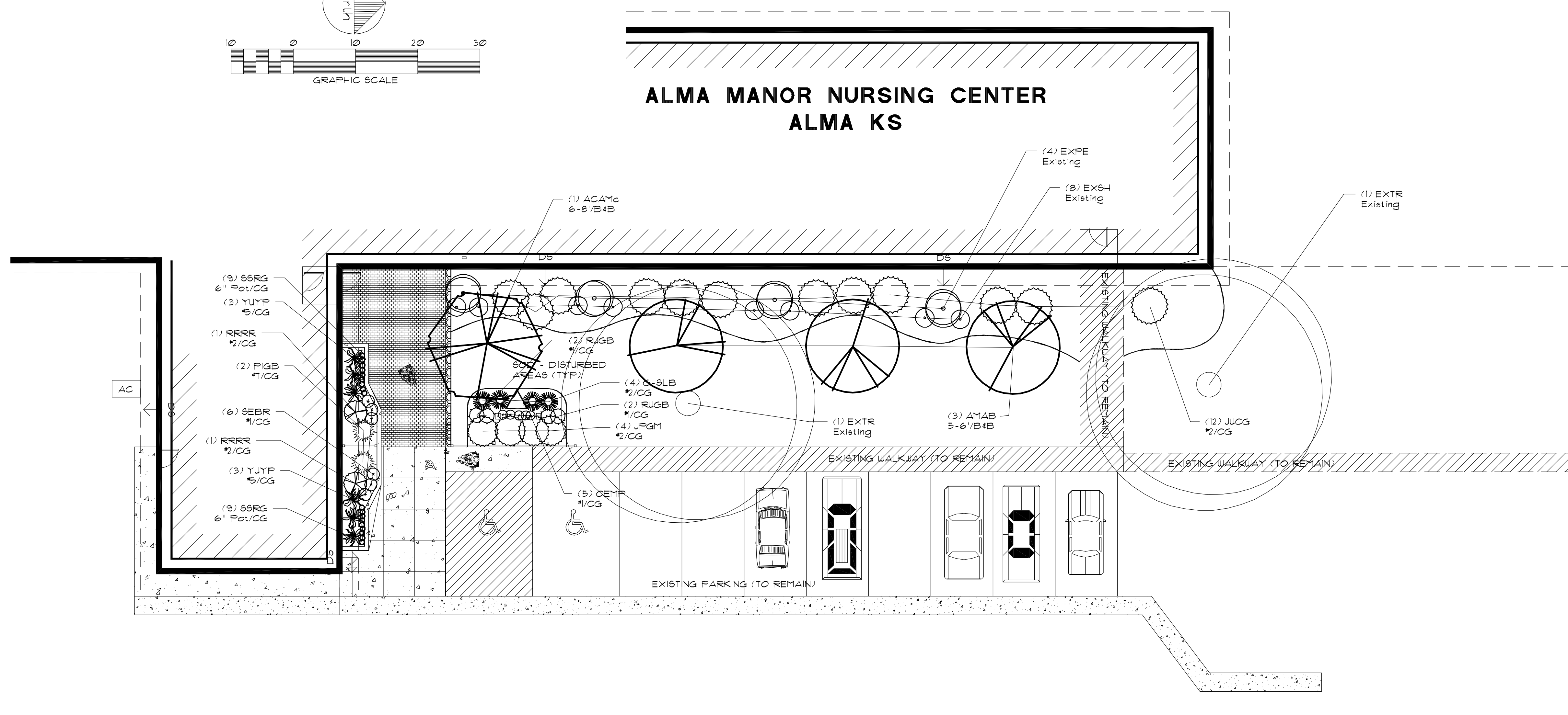

MASTER & PLANTING PLAN

1"=10'

MASTER PLANT TABLE

Quantity	Code Name	Scientific Name	Common Name	Planting Size
1	ACAMc	<i>Acer ginnala</i>	Amur maple/clump	6-8'/B4B
3	AMAB	<i>Amelanchier 'Autumn Brilliance'</i>	Aut. Brill. Serviceberry	5-6'/B4B
4	G-SLB	<i>Schizachyrium scoparium 'Blaze'</i>	Little Bluestem 'Blaze'	2/CG
4	JFGM	<i>Juniperus procumbens 'Greenmound'</i>	Greenmound Procumbens Juniper	2/CG
12	JUCG	<i>Juniperus chinensis 'Gold Coast'</i>	Gold Coast Juniper	2/CG
5	OEMP	<i>Oenothera missouriensis</i>	Missouri primrose	1/CG
2	FIGB	<i>Picea pungens 'Glabosa'</i>	Globe Blue spruce	7/CG
2	RRRR	<i>Rosa rugosa</i>	Rugosa Rose	2/CG
4	RUGB	<i>Rudbeckia 'Goldsturm'</i>	Goldsturm blackeyed susan	1/CG
6	SEBR	<i>Sedum spectabile 'Brilliant'</i>	Brilliant sedum	1/CG
18	SSRG	<i>Sedum spp. 'Rosy Glow'</i>	Rosy Glow sedum	6" Pot/CG
6	YUYF	<i>Yucca filamentosa</i>	Adam's Needle Yucca	5/CG

LANDSCAPE LEGEND

- EXISTING TREES/SHRUBS/PERENNIALS
- PROPOSED TREES
- PROPOSED PERENNIALS
- PROPOSED PERENNIAL GRASSES
- PROPOSED SHRUBS
- 30' EXP. AGG. CONCRETE PAVER (TYP. - SEE DETAIL)
- STEEL EDGING (TYP. - SEE DETAIL)
- BUILDING HYDRANT (TYP.)
- BUILDING DOWNSPOUT (TYP.)

HITTLE
 LANDSCAPE ARCHITECTS
 P.O. Box 83 / 700 Gillespie Drive
 Manhattan, KS 66505-0083
 voice: (785) 539-7772
 fax: (785) 539-6050
 E-mail: lhittle@kansas.net

ALL IDEAS, PERSONS AND PLANS INDICATED OR REPRESENTED BY THIS DRAWING ARE OWNED BY AND THE PROPERTY OF HITTLE LANDSCAPE ARCHITECTS. NONE OF THE IDEAS, DESIGNS, OR PLANS SHALL BE USED BY OR DISCLOSED TO ANY PERSON, FIRM, OR CORPORATION FOR ANY PURPOSE WHATSOEVER WITHOUT THE WRITTEN PERMISSION OF HITTLE LANDSCAPE ARCHITECTS. WRITTEN PERMISSION ON THESE DRAWINGS SHALL BE OBTAINED FROM HITTLE LANDSCAPE ARCHITECTS. HITTLE LANDSCAPE ARCHITECTS SHALL BE RESPONSIBLE FOR ALL DIMENSIONS AND CONDITIONS ON THE JOB AND THIS OFFICE MUST BE NOTIFIED OF ANY VARIATION FROM THE DIMENSIONS AND CONDITIONS SHOWN ON THESE DRAWINGS. SHOP DETAILS MUST BE SUBMITTED TO THIS OFFICE FOR APPROVAL BEFORE PROCEEDING WITH FABRICATION OR INSTALLATION. REPRODUCTION OF THESE DRAWINGS IS A CRIMINAL OFFENSE UNDER 18 U.S.C. SEC. 360.

ALMA MANOR NURSING HOME
 Entry Renovation Plan
 234 Manor Circle
 Alma, KS.

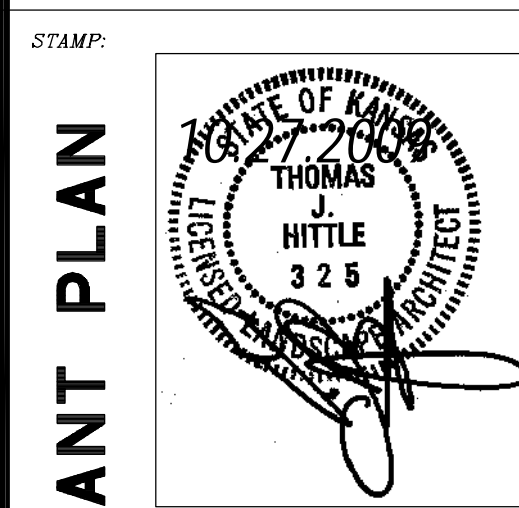

MASTER PLAN & PLANT PLAN

REVISION: N.A.
 DRAWN: T/JH
 CHECKED: T/JH
 DATE: N.A.
 PROJECT NO.: N.A.
 SCALE: N.A.
 FILE NAME: file.dwg

